



# ALL NEW DAX CHIN STRAP



## FEATURES

- **SECURE FIT** – Provides a secure fit and prevents DAX hard hats from getting bumped off, blown off from high winds, or falling off in confined or unusual work positions.
- **CHIN STRIP MOUNTING ANCHOR** – Mounting anchors slide under the top side of the rivet for a secure hold.
- **LOCKING CHIN STRAP** – Unique magnetic clip locking technology automatically engages securely for quick and easy opening and closing.
- **ADJUSTABLE STRAP** – Chin strap easily adjusts from 1.5” minimum to 11” maximum for a custom and comfortable fit.
- **COMPATABILITY** – Attaches to all DAX Full Brim and DAX Cap hard hats. \*DAX hard hat sold separately.
- **MSRP** – \$13.75
- **DEALERS** – \$8.45



CHIN STRAP (LEFT)

CHIN STRAP (RIGHT)

| STYLE          | PART #   | UPC CODE     |
|----------------|----------|--------------|
| DAX CHIN STRAP | HDS-21BK | 879501000006 |



DAX FULL BRIM



DAX CAP



CHIN STRAP (ENGAGED)



# DAX CHIN STRAP INSTALLATION GUIDE



## CHIN STRAP - LEFT

## SUSPENSION UNIT

## CHIN STRAP - RIGHT

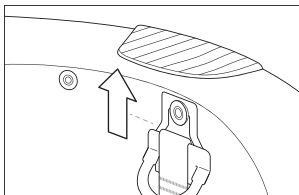
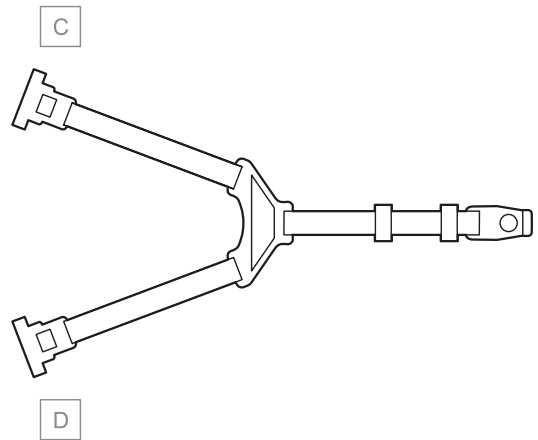
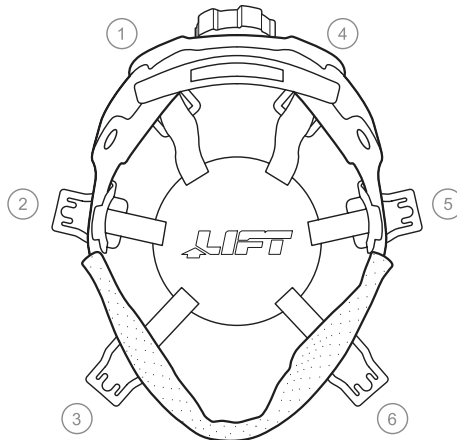
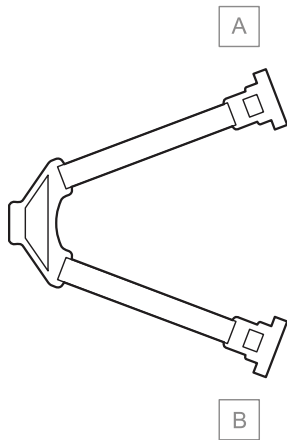

### STEP 1 - REMOVE SUSPENSION SYSTEM

Remove the #1, 3, 4 and 6 Suspension System Mounting Points from helmet by looping a finger under black straps leading from the central leather dome and holding them flat against the side of the helmet. Pull the strap away from the top of the helmet while pressing it firmly against the helmet shell being careful not to bend the metal bracket. The metal bracket will disconnect away from the rivet.

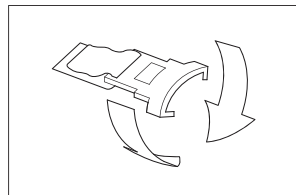

### STEP 2 - INSTALL CHIN STRAP CLIPS

Place the Chin Strap Mounting Anchor between thumb and pointer finger. Apply pressure so that the mounting anchor bends into itself slightly. This will allow insertion through the plastic "loop" in the rivet mounting assembly.

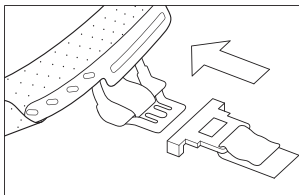

### STEP 2 (CONT.)

Insert Chin Strap Mounting Anchor through Suspension System Mounting Clips. Follow the same procedure for mounting point #3, 4 and 6. The teeth on the ends of the Chin Strap mounting anchor will clamp onto the squared bottom of the metal bracket once reinstalled onto the hard hat rivet.

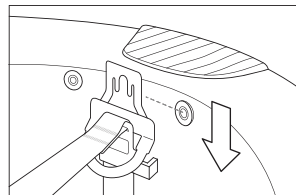

### STEP 3 - REINSTALL SUSPENSION SYSTEM

To reinstall, line up the metal bracket's slightly bent teeth so that they can slide under the rivet. Grasping the same black strap from step #1, apply pressure toward the dome of the helmet while holding the Suspension System Mounting Point flat against the dome of the helmet. The teeth will "click" into place around the rivet.

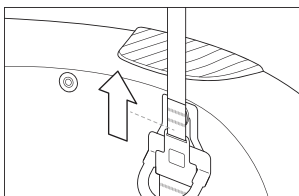

### STEP 4 - CHIN STRIP MOUNTING ANCHOR

Ensure that the Chin Strap Mounting Anchor's top (The curved side opposite the "T") slides under the top side of the rivet for a secure hold by carefully pulling the strap towards the center of the helmet until the plastic clicks under the rivet. Repeat for suspension mounting points #3, 4 and 6.

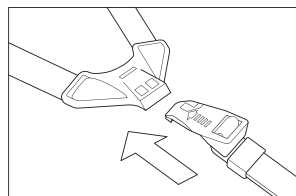

### LOCKING CHIN STRAP

To engage chin strap buckle, place the top clip on the outside of the receiver. The magnetic clip will automatically engage securely. To remove the chin strap buckle, grasp the top and bottom with your thumb and pointer finger and squeeze. The top clip will slide upwards and disengage the magnet.